

MPU36102 Magnetic Pickup

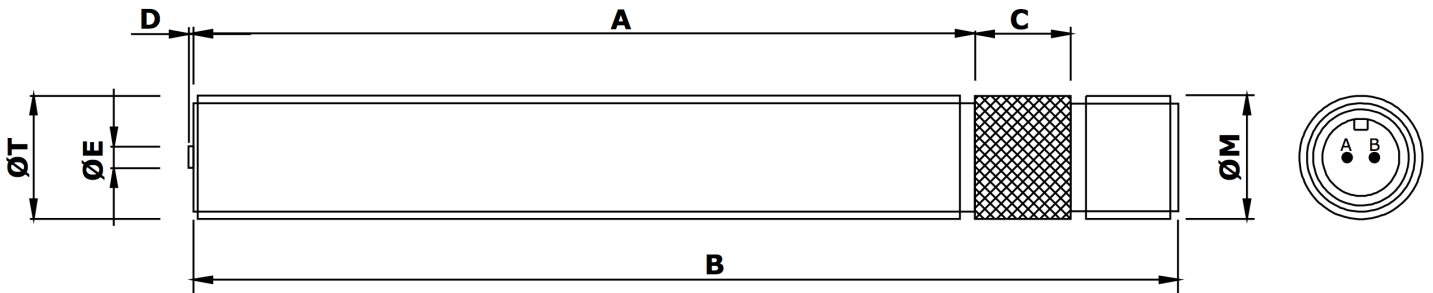

Mechanical specification

dimensions in mm unless otherwise stated

<i>Dimension</i>		<i>Part number</i>
A	102	
B	128	
C	12 medium diamond knurl	
D	0.6 nominal	
ØE	Ø2.8 Pole Piece	
ØM	5/8" x 24 tpi UNEF-2A (connector thread)	
ØT	5/8" x 18 tpi UNF-2A (body thread)	MPU36102-I
<i>or</i>	M16 x 1.5 6g	MPU36102-M
Main body material	Stainless Steel	
End Bobbin face	Polypropylene	
Locknut	1 off supplied as standard	

Electrical specification

Resistance 250Ω nominal @ 20°C

Inductance

Operating temperature range -54°C to +120°C

Voltage output

Minimum speed

Termination MS (screw) 10SL4P (2-pin integral plug)

Mating connector MS (screw) 10SL4S (2-pin line socket)

For the full data sheet and/or a quotation please contact us: sales@logitechelectronics.com

MADE IN THE UK

Reliability, Guaranteed



Logitech Electronics Limited

e: sales@logitechelectronics.com

t: +44 (0)1952 820444

Design and Manufacture of Electronic Systems and Instrumentation. Supply of Sensors and Transducers

www.logitechelectronics.com

Lane End | Church Aston | Newport | Shropshire | TF10 9JJ | UK