

MPU3663 Magnetic Pickup

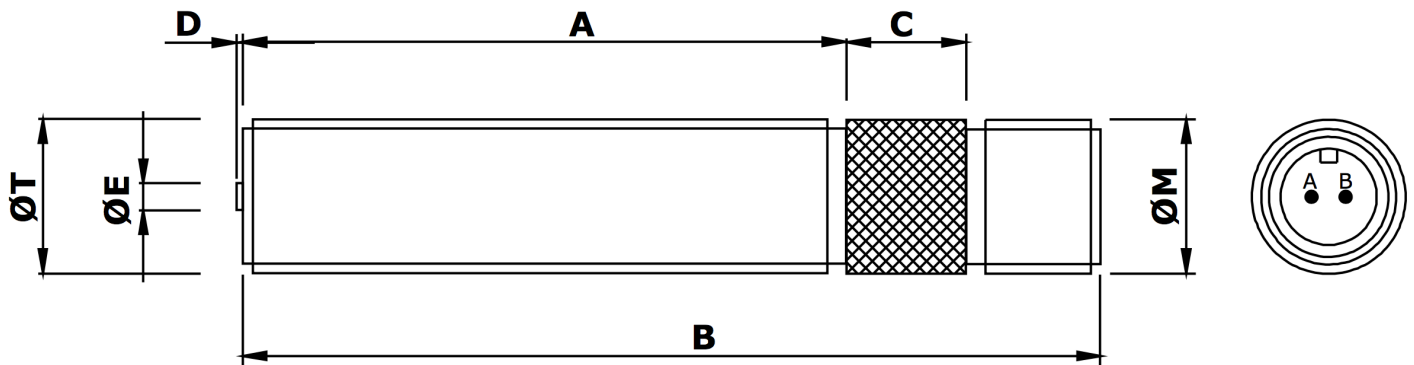

Mechanical specification

dimensions in mm unless otherwise stated

Dimension	Part number	
A	63	
B	90	
C	12 medium diamond knurl	
D	0.6 nominal	
ØE	Ø2.8 Pole Piece	
ØM	5/8" x 24 tpi UNEF-2A (connector thread)	
ØT	5/8" x 18 tpi UNF-2A (body thread)	MPU3663-I
or	M16 x 1.5 6g	MPU3663-M
Main body material	Stainless Steel	
End Bobbin face	Polypropylene	
Locknut	1 off supplied as standard	

Electrical specification

Resistance 250 Ω nominal @ 20°C

Inductance

Operating temperature range -54°C to + 120°C

Voltage output

Minimum speed

Termination MS (screw) 10SL4P (2-way integral plug)

Mating connector MS (screw) 10SL4S (2-way line socket)

For the full data sheet and/or a quotation please contact us: sales@logitechelectronics.com

MADE IN THE UK

Reliability, Guaranteed



Logitech Electronics Limited

e: sales@logitechelectronics.com
t: +44 (0)1952 820444

Design and Manufacture of Electronic Systems and Instrumentation. Supply of Sensors and Transducers
www.logitechelectronics.com

Lane End | Church Aston | Newport | Shropshire | TF10 9JJ | UK