

HES36102

Hall Effect Sensor

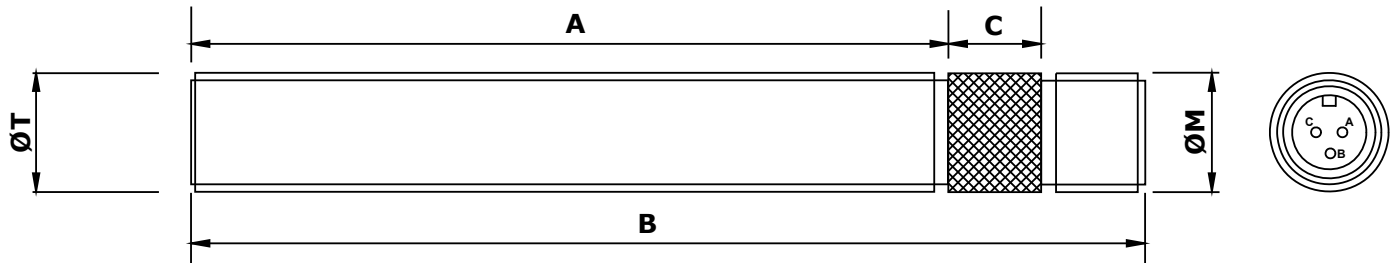

Mechanical specification

dimensions in mm unless otherwise stated

<i>Dimension</i>		<i>Part Number</i>
A	102	
B	104	
C	12 medium diamond knurl	
ØT	5/8" x 18 tpi UNF-2A (body thread)	HES36102-I
or	M16 x 1.5 6g	HES36102-M
Main body material	Stainless Steel	
End face	Epoxy sealed sensing face	
Locknut	1 off supplied as standard	

Electrical specification

Power supply +5V DC minimum to +30V DC maximum
(ideal for 12V or 24V automotive applications)

Protection Reverse polarity, overvoltage and momentary transient surge, and short circuit (output to ground)

Operating temperature range -20°C to +125°C

Target magnet North pole to sensor

Target distance 1mm to 7mm depending on magnets used

Operating magnetic force $\leq 180\text{G}$

Magnetic release force $\leq 75\text{G}$

Differential magnetic force 25G minimum

Output signal Open collector with 4K7 pull-up

Output low voltage level 0.4V maximum

Output sinking current 50mA maximum

Operating frequency range 0 to 20kHz

Termination MS screw 10SL-3P (3-way integral plug)

Connections
A = Vout
B = Vs
C = 0V / Ground

Mating connector MS screw 10SL-3S (3-way line socket, not supplied)

MADE IN THE UK

Reliability, Guaranteed



Logitech Electronics Limited

e: sales@logitechelectronics.com
t: +44 (0)1952 820444

Design and Manufacture of Electronic Systems and Instrumentation. Supply of Sensors and Transducers

www.logitechelectronics.com

Lane End | Church Aston | Newport | Shropshire | TF10 9JJ | UK