

Zero Velocity
 Gear Tooth Sensor
 Internal Bias Magnet
 For Detection of Ferrous Targets

HES3660NS

Hall Effect Sensor

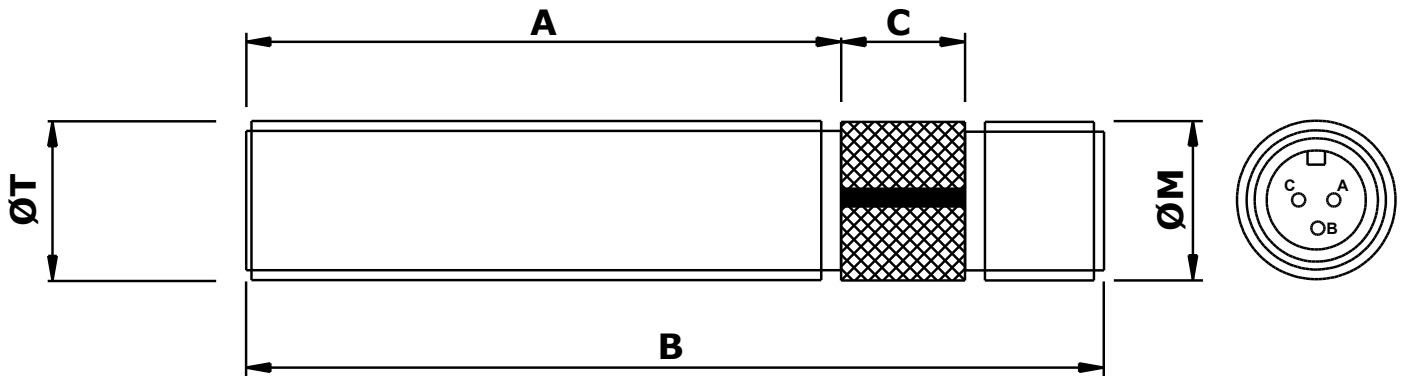

Mechanical specification

dimensions in mm unless otherwise stated

<i>Dimension</i>		<i>Part Number</i>
A	60	
B	87 nominal	
C	10 medium diamond knurl with alignment groove	
ØT	5/8" x 18 tpi UNF-2A (body thread)	HES3660NS-I
or	M16 x 1.5 6g	HES3660NS-M
Main body material	Stainless Steel	
End face	Stainless steel – sealed solid end suitable for permanent liquid immersion [see note 1]	
Locknut	1 off supplied as standard	

Electrical specification

Power supply	5V DC — 30V DC
Protection	Reverse polarity, overvoltage and momentary transient surge, and short circuit (output to ground, output to supply)
Supply Current (output low)	17mA max
Supply Current (output high)	5mA min
High Output Voltage (O/C)	5.2V typical / 4.8V min
Low Output Voltage (O/C)	0.2V typical, 0.65V max
High Output Voltage ($I_{out} = 10/20mA$)	4.5V min / 4.0V min
Low Output Voltage ($I_{out} = 10/20mA$)	0.8V max / 1.0V max
Output Current (Sink or Source)	80mA max
Operating Temperature Range	-40°C to +150°C
Operating Frequency Range	0–8000Hz
Operating Air Gap (AG)	0–3.0mm
Output Polarity	The groove must be aligned with the direction of rotation of the tooth as it passes the face of the sensor. The polarity may be reversed by rotating the sensor through 180°.
Termination	MS screw 10SL3P (3-pin integral plug)
Connections	Pin A = V_s Pin B = 0V Pin C = Output
Mating Connector	MS screw 10SL3S (3-way line socket, not supplied) [see note 2]

Notes:

1. This sensor carries our “grade 2 immersible” rating – the sensor end is sealed for applications requiring permanent immersion of the sensing tip only.
2. Mating line connectors (straight or 90°, complete with cable bush & clamp) are available to order separately.

MADE IN THE UK

Reliability, Guaranteed



Logitech Electronics Limited

e: sales@logitechelectronics.com

t: +44 (0)1952 820444

Design and Manufacture of Electronic Systems and Instrumentation. Supply of Sensors and Transducers

www.logitechelectronics.com

Lane End | Church Aston | Newport | Shropshire | TF10 9JJ | UK