

# HES3676S

## Hall Effect Sensor

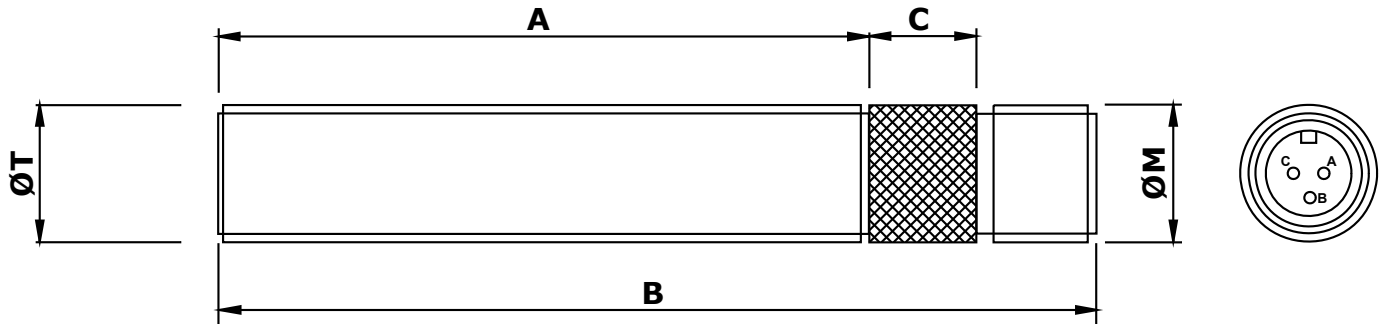

### Mechanical specification

dimensions in mm unless otherwise stated

<i>Dimension</i>		<i>Part Number</i>
<b>A</b>	76	
<b>B</b>	104	
<b>C</b>	12 medium diamond knurl	
<b>ØM</b>	5/8" x 24 tpi UNEF-2A (connector thread)	
<b>ØT</b>	5/8" x 18 tpi UNF-2A	<b>HES3676S-I</b>
<i>or</i>	M16 x 1.5 6g	<b>HES3676S-M</b>
<b>Main body material</b>	Stainless Steel	
<b>End face</b>	Stainless Steel — sealed end suitable for permanent liquid immersion	
<b>Locknut</b>	1 off supplied as standard	

# Electrical specification

<b>Power supply</b>	+5V DC minimum to +30V DC maximum (ideal for 12V or 24V automotive applications)
<b>Protection</b>	Reverse polarity, overvoltage and momentary transient surge, and short circuit (output to ground)
<b>Operating temperature range</b>	-20°C to +125°C
<b>Target magnet</b>	North pole to sensor
<b>Target distance</b>	1mm to 7mm depending on magnets used
<b>Operating magnetic force</b>	≤180G
<b>Magnetic release force</b>	≤75G
<b>Differential magnetic force</b>	25G minimum
<b>Output signal</b>	Open collector with 4K7 pull-up
<b>Output low voltage level</b>	0.4V maximum
<b>Output sinking current</b>	50mA maximum
<b>Operating frequency range</b>	0 to 20kHz
<b>Termination</b>	MS screw 10SL-3P (3-way integral plug)
<b>Connections</b>	A = $V_{out}$ B = $V_s$ C = 0V / Ground
<b>Mating connector</b>	MS screw 10SL-3S (3-way line socket, not supplied) [see note 2]

Notes:

1. This sensor carries our “grade 2 immersible” rating – the sensor end is sealed for applications requiring permanent immersion of the sensing tip only.
2. Mating line connectors (straight or 90°, complete with cable bush & clamp) are available to order separately.

MADE IN THE UK

*Reliability, Guaranteed*



**Logitech Electronics Limited**

e: sales@logitechelectronics.com

t: +44 (0)1952 820444

*Design and Manufacture of Electronic Systems and Instrumentation. Supply of Sensors and Transducers*

www.logitechelectronics.com

Lane End | Church Aston | Newport | Shropshire | TF10 9JJ | UK