

Intrinsically Safe

Plug and Socket Type
Speed Sensor

MPEX3659 Magnetic Pickup

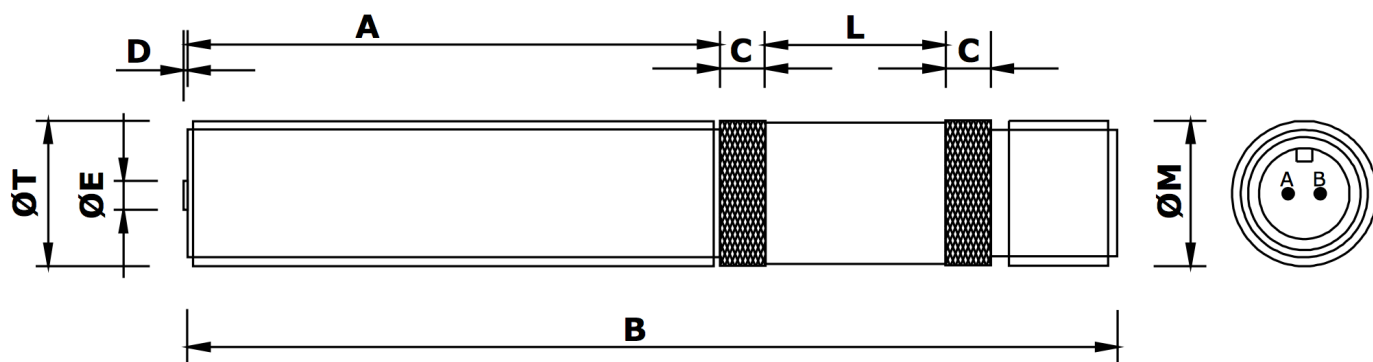

Mechanical specification

dimensions in mm unless otherwise stated

<i>Dimension</i>		<i>Part number</i>
A	59	
B	103 nominal	
C	5 medium diamond knurl	
D	0.4 nominal	
L	20 plain area for affixing label	
ØE	3.17 pole piece	
ØM	5/8" x 24 tpi UNEF-2A (connector thread)	
ØT	5/8" x 18 tpi UNF-2A (body thread)	MPEX3659-I
<i>or</i>	M16 x 1.5 6g	MPEX3659-M
Main body material	Stainless Steel	
End Bobbin face	Polypropylene	
Locknut	1 off as standard	

Electrical specification

Resistance 450 Ω nominal @ 20°C

Inductance 135mH nominal

Operating temperature range -40°C to + 120°C [see note 2]

Voltage output Clamped at 4V peak nominal, 4.97V maximum

Minimum speed 30 mm/second [see note 1]

Polarity Pin A negative with respect to Pin B as target approaches

Termination MS (screw) 10SL4P (2-pin integral plug)

Mating connector MS (screw) 10SL4S (2-pin line socket)

Notes:

1. Minimum speed in mm/second to generate 100mV peak to peak typical output measured across a 10K load using a 60 tooth mild steel gear wheel of $\varnothing 6''$, rotating at 1000 rpm and with an air gap setting of 0.01".
2. The permitted ambient temperature range is dependent on temperature class, refer to T_a .
3. Complies with the Dielectric Strength requirements of EN60079-11, Section 10.3.

Entity parameters

U_i (V)	I_i (mA)	P_i (W)	C_i (nF)	L_i (μ H)
30	160	0.75	0	0

U , I and P for the selected barrier must not exceed the values listed above.

Ambient Temperature T_a

The equipment is certified for use in ambient temperatures in the range of -40°C to $+120^\circ\text{C}$ and should not be used outside this range. The range is restricted according to temperature class as follows:

T6	T5	T4	T3
-40°C to $+57^\circ\text{C}$	-40°C to $+72^\circ\text{C}$	-40°C to $+107^\circ\text{C}$	-40°C to $+120^\circ\text{C}$

Applicable Special Conditions

This equipment has an electrically isolated pole piece protruding from the centre of its coil, having capacitance of up to 17pF. The user must determine the suitability of the equipment for the specific application. Precaution must be taken to avoid the accumulation of electrostatic charge on this part.

Approval

Ex ia IIC T6...T3 Ga

Baseefa19ATEX0151X

IECEX BAS 20.0002X

MPEX Series

Logitech Electronics Limited
Lane End
Church Aston
Newport
Shropshire
TF10 9JJ
UK



Certificates and user guides are available to view and download from our website:
www.logitechelectronics.com/ex/download

MADE IN THE UK

Reliability, Guaranteed



Logitech Electronics Limited

e: sales@logitechelectronics.com

t: +44 (0)1952 820444

Design and Manufacture of Electronic Systems and Instrumentation. Supply of Sensors and Transducers

www.logitechelectronics.com

Lane End | Church Aston | Newport | Shropshire | TF10 9JJ | UK